

REY2535

CABINET W/ WHEELS & GLASS DOORS

www.reytek.com

304 STAINLESS STEEL
CONSTRUCTION

10ea. ADJUSTABLE SHELVES
22mm INCREMENTS
MAX CAPACITY 75 lbs. PER SHELF

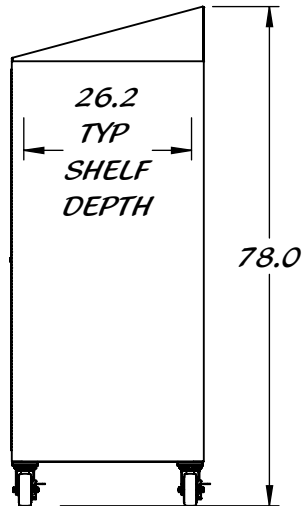
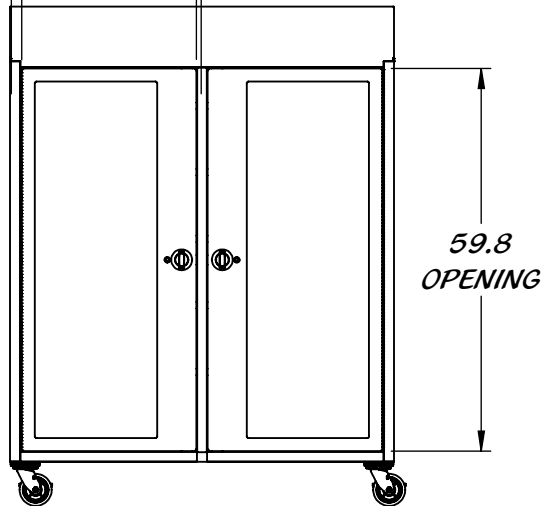
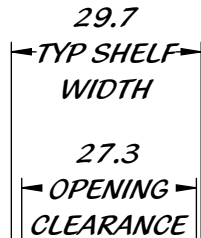
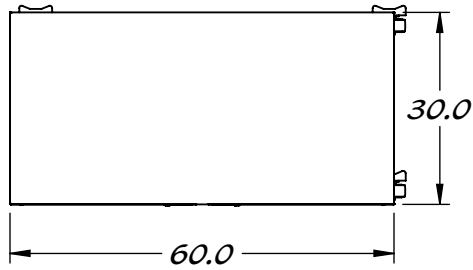

2-POINT LATCHES
w/ LOCKS

SS SWIVEL CASTERS w/ BRAKES
POLYURETHANE TREAD

TEMPERED GLASS WINDOWS
w/ SILICONE GASKETS